



**MASTER-FRIGO** panels are Insulated Metal Panels composed of steel skins laminated to a minimum of 1.6-inch polyisocyanurate foam core (min 2.3 pcf density).

**MASTER-FRIGO** panels have a tongue and groove joining system are specially designed for use in all types of projects related to refrigeration industry, like the agro-food industry for refrigerated transport and storage of frozen and deep-frozen food.

**MASTER-FRIGO** panels are available in seven different thicknesses. They come in two different exterior finishes (standard and flat) and two different interior finishes (standard and flat), as well as a wide range of available colours.

## Master-FRIGO cold-room panels

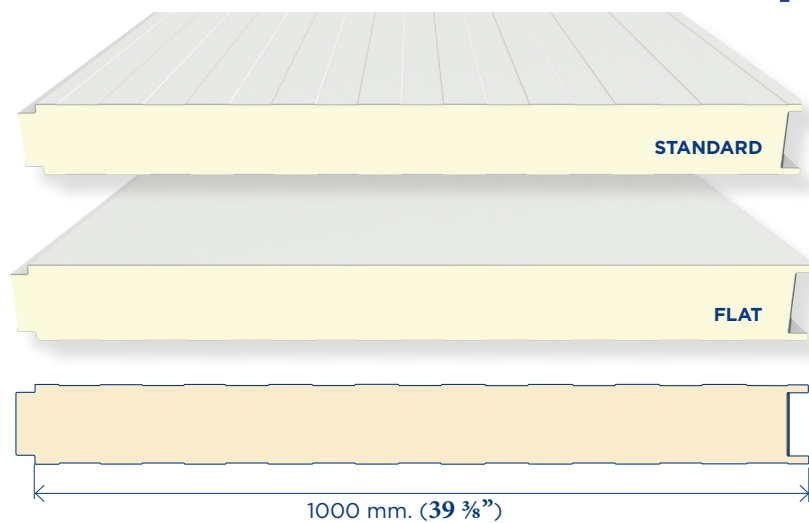

### TECHNICAL SPECIFICATIONS Master-Frigo cold-room panels

	VALUES
<b>Panel thickness</b>	40, 50, 60, 80, 100, 120, 150 mm. 1 <sup>9</sup> / <sub>16</sub> , 1 <sup>3</sup> / <sub>32</sub> , 2 <sup>3</sup> / <sub>8</sub> , 3 <sup>5</sup> / <sub>32</sub> , 3 <sup>15</sup> / <sub>16</sub> , 4 <sup>3</sup> / <sub>4</sub> , 6, inch.
<b>Useable width</b>	1000 mm. (39 3/8")
<b>Length</b>	Up to 11.900 mm. (39 ft.)
<b>Field of application</b>	Cold room
<b>Thicknesses of outer face</b>	mm 0.5 / 0.6 / 0.7 GAUGE 26 / 24 / 22
<b>Thicknesses of inner face</b>	mm 0.5 / 0.6 / 0.7 GAUGE 26 / 24 / 22
<b>Exterior face</b>	G90 galvanized or AZ50 aluminum-zinc, coated steel in 26 GA and above
<b>Interior face</b>	G90 galvanized or AZ50 aluminum-zinc, coated steel in 26 GA and above
<b>Coatings</b>	Polyester 25um (1 mil) PVDF 25um / 35um (1 mil / 1.38 mils) Granite HDX / SDP 50 (2,16 mils)
<b>Outer ribbing</b>	Standard / flat
<b>Inner ribbing</b>	Standard / Flat
<b>Type of core</b>	Polyisocyanurate (PIR)
<b>Core Density</b>	40 Kg/m <sup>3</sup> (2.3 PCF)

## Functions and benefits of **MASTER-Frigo** panels

Excellent aesthetics  
 High thermal insulation capacity  
 High mechanical strength  
 High dimensional stability  
 Water vapour tight

A versatile material that allows any configuration  
 Quick to install and easy to maintain  
 Easily removable  
 Made to measure, avoids waste  
 Resistant to aggressive environment

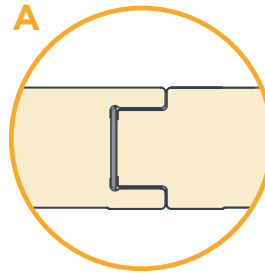
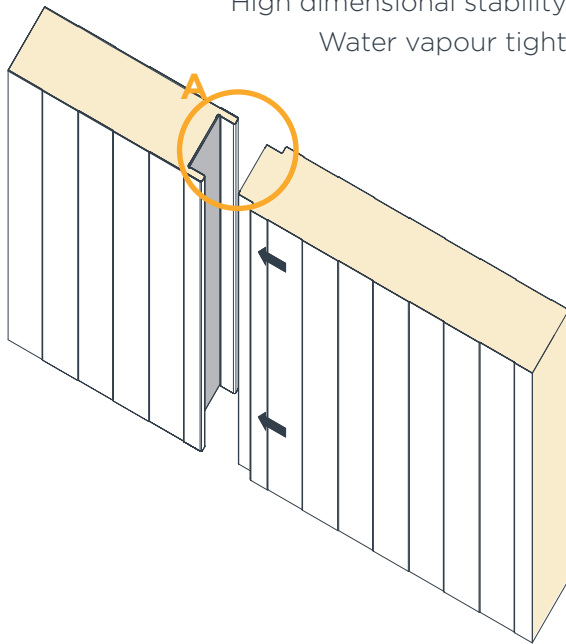

Panel thickness	Panel weight	U - Value	R - Value
mm (")	LB/ft <sup>2</sup>	BTU/Hr ft <sup>2</sup> °F	Hr ft <sup>2</sup> °F/BTU
40 (1 9/16")	2.06	0.097	10.299
50 (1 31/32")	2.14	0.075	13.322
60 (2 3/8")	2.22	0.060	16.547
80 (3 1/2")	2.38	0.044	22.712
100 (3 15/16")	2.55	0.035	28.745
120 (4 3/4")	2.71	0.029	34.728
150 (6 ")	2.96	0.023	43.634



### Testing and approvals:

Master panel cold-room panels meet the most demanding requirements. We have large experience in producing insulated metal panels in our continuous production line.

TEST	TEST METHOD	RESULTS
Fire	ASTM E 84	Flame spread index 20 Smoke developed index 300
Strength	ASTM E 8	> 32 ksi steel

